



IT

Conformità
Conforme alla Direttiva di Compatibilità Elettromagnetica 2014/30/UE e alla Normativa di Compatibilità Elettromagnetica 2016 SI 2016:1091.

Avvertenze per l'installazione

L'apparecchio deve essere impiegato per installazione fissa in interno, ambienti chiusi e asciutti.

AVVERTENZA

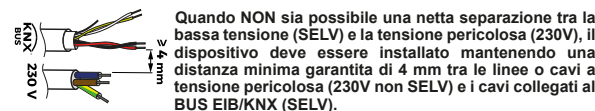

- Non collegare il dispositivo direttamente alla 230 V.
L'apparecchio deve essere installato e messo in servizio da un installatore abilitato.

NOTA:

- 1. Selezionare l'altezza di installazione per consentire una visuale diretta
2. Non esporre alla luce solare diretta

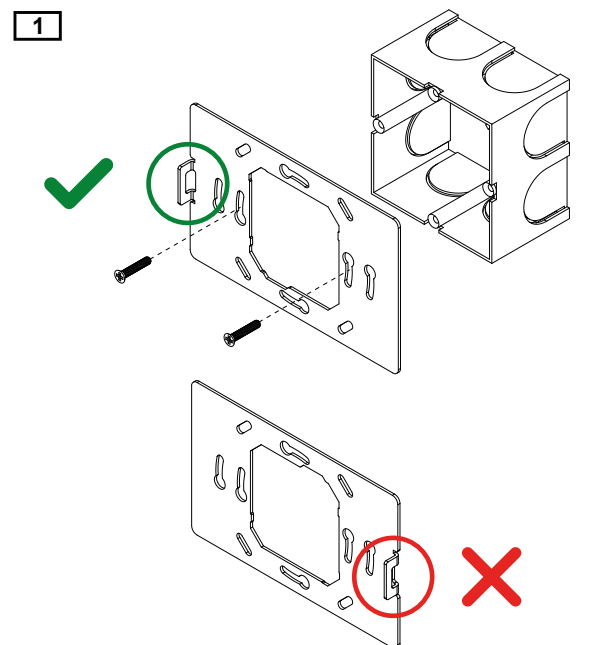
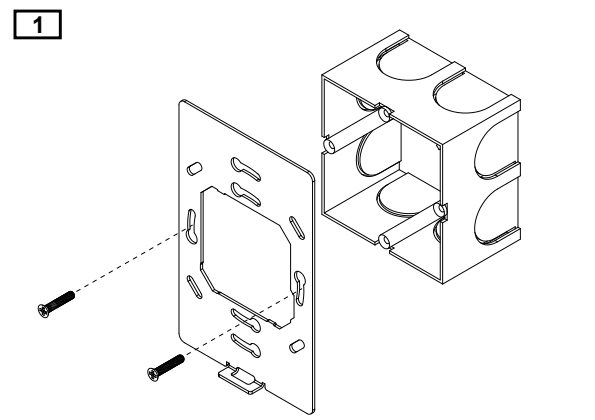

Smaltimento

Il simbolo del cassonetto barrato indica che il prodotto alla fine della propria vita utile deve essere raccolto separatamente dagli altri rifiuti.

EN

Compliance
Compliant with Electromagnetic Compatibility Directive 2014/30/EU and with Electromagnetic Compatibility Regulations 2016 SI 2016:1091.

Installation instructions

he device may be used for permanent indoor installations in dry locations within wall box mounts.

WARNING

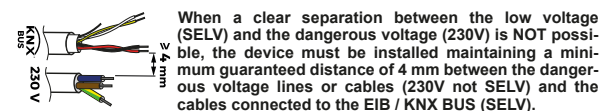

- The device must not be connected to 230V cables.
The prevailing safety rules must be heeded.

INSTALLATION NOTES:

- 1. Select installation height to allow for direct line of sight
2. Do not expose to direct sun light

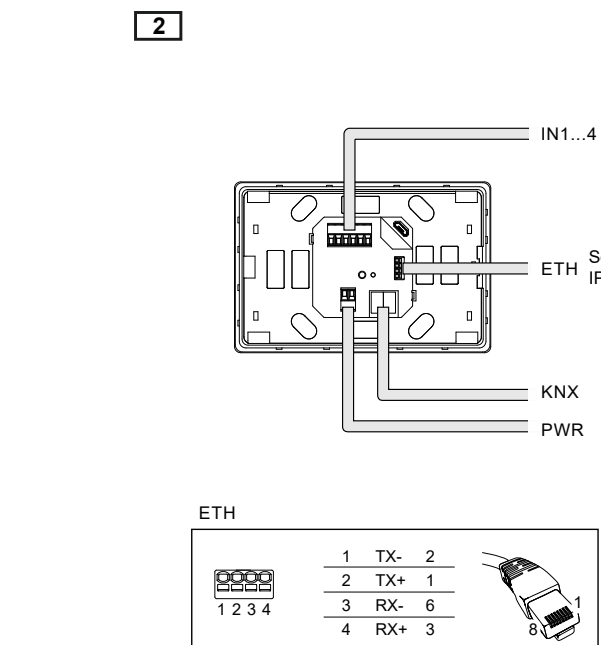
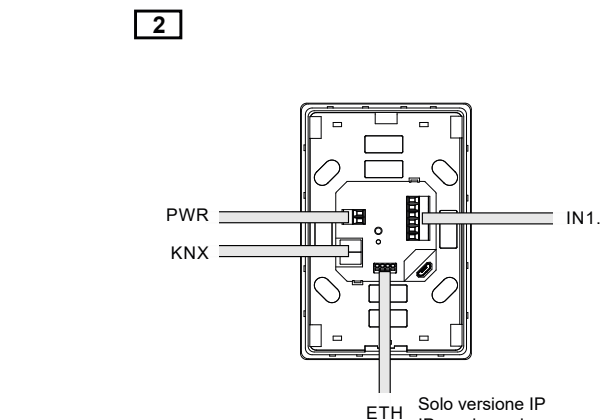

Disposal

The crossed-out bin symbol on the equipment or packaging means the product must not be included with other general waste at the end of its working life.

DE

Vorschriften
Erfüllt die Richtlinie 2014/30/EU zur elektromagnetischen Verträglichkeit und 2016 S.I. 2016: 1091 Vorschriften zur elektromagnetischen Verträglichkeit.

Installationshinweise

Das Gerät muss für die Inneninstallation in geschlossenen und trockenen Umgebungen verwendet werden.

WARNUNG

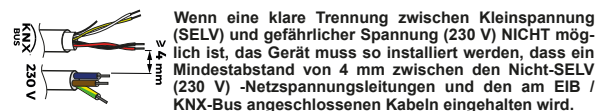

- Das Gerät darf nicht direkt an 230V Leitungen angeschlossen werden.
Das Gerät muss von einem autorisierten Installateur installiert und in Betrieb genommen werden.

INSTALLATIONSANMERKUNGEN:

- 1. Wählen Sie eine Installationshöhe, die eine direkte Blicklinie ermöglicht
2. Installieren Sie dieses Produkt nicht im direkten Sonnenlicht

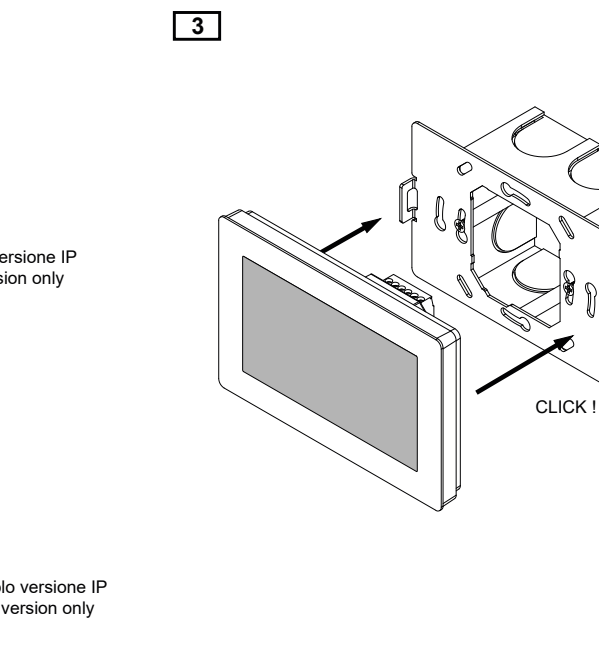
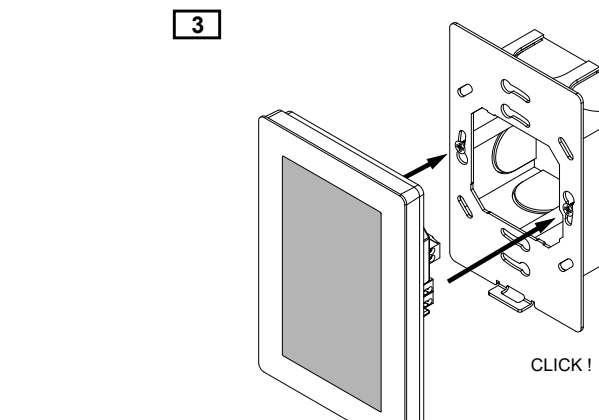

Entsorgung

Das Symbol des mit X gekennzeichneten Behälters zeigt an, dass das Produkt am Ende seiner Nutzungsdauer getrennt von anderen Abfällen gesammelt werden muss.

ES

Compliance
Cumple con la Directiva de Compatibilidad Electromagnética 2014/30/UE y las Normativas de Compatibilidad Electromagnética 2016 S.I. 2016:1091.

Advertencias para la instalación

El aparato se debe usar para instalación fija en interior, ambientes cerrados y secos.

ADVERTENCIA

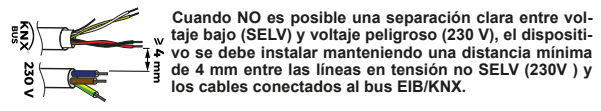

- El dispositivo no debe conectarse directamente a cables de 230V.
El aparato se debe instalar y poner en servicio por un instalador habilitado.

NOTAS DE INSTALACIÓN:

- 1. Seleccionar la altura de instalación de forma que permita línea de visión directa
2. No instalar en lugares donde la luz solar incida directamente

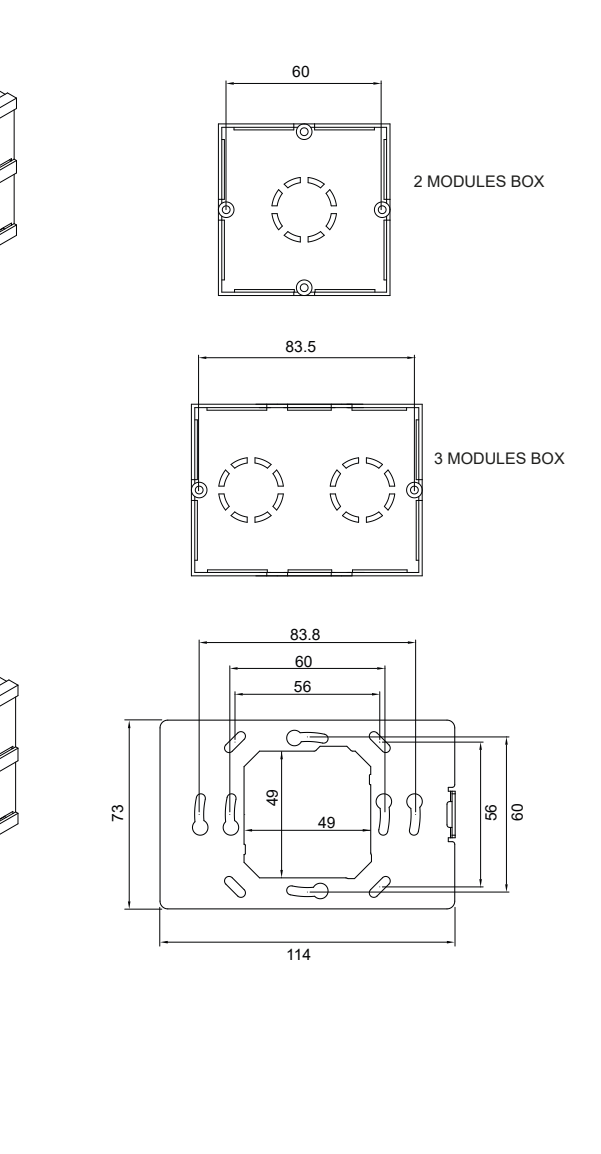

Eliminación

El símbolo del contenedor tachado indica que el producto al final de su vida útil debe ser recogido de manera separada de los demás residuos.

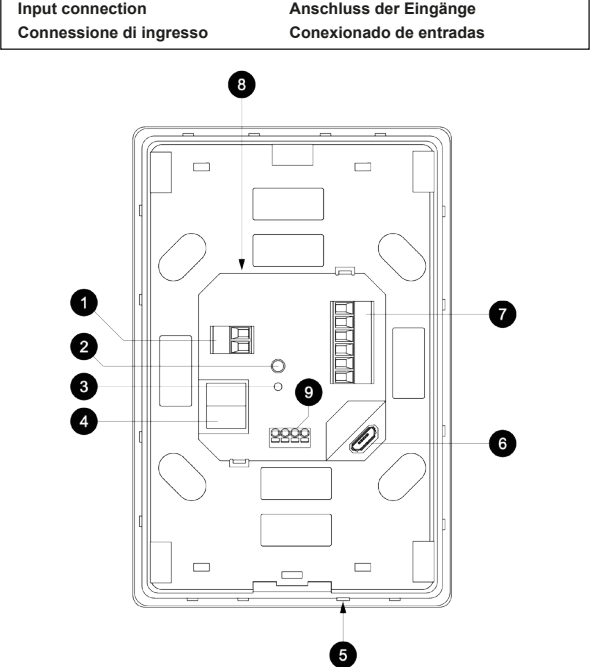

- 1. Connettore di alimentazione (12-30 VDC)
2. Pulsante di programmazione KNX
3. LED di programmazione KNX

Temperature probe ref.: TS01101ACC
Sensore di temperatura ref.: TS01101ACC
Temperatursonden TS01101ACC
Sondas de temperaturaa TS01101ACC

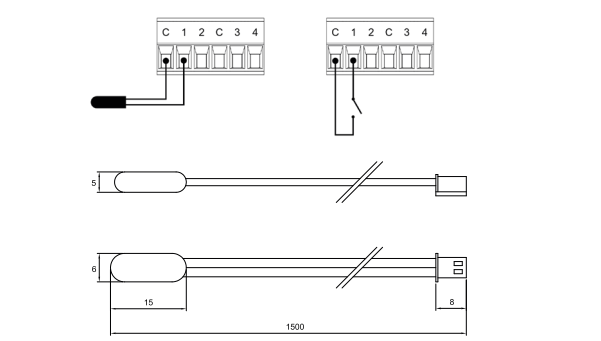

RTC battery replacement
Sostituzione batteria RTC
RTC Backup-Batteriewechsel
Reemplazo de la batería RTC

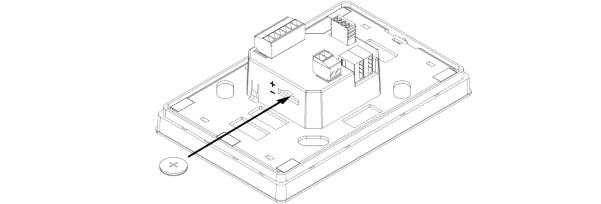

Ethernet wiring IP version
Cablaggio ethernet versione IP
Ethernet-Anschluss
Conexionado Ethernet

Table with 3 columns: TP43M11KNX/TP43I21KNX-GL, Description, RJ45. Rows show TX-, TX+, RX-, RX+ connections.

Eelectron S.p.A.
Via Monteverdi 6
I-20025 Legnano (MI) - Italia
Tel: +39 0331 500802
Email: info@eelectron.com Web: www.eelectron.com